



RICHMONDS



# Mon Crescent, Bitterne, Southampton, SO18 5QU

£299,995

An attractive detached bungalow offering well-proportioned accommodation, set on a generous plot with a large rear garden and offered with no forward chain.

The property comprises two double bedrooms, a spacious lounge, a modern fitted kitchen/dining room with adjoining utility area, and a bright conservatory overlooking the garden. A well-appointed bathroom completes the internal accommodation.

Further benefits include gas central heating, double glazing throughout, and a converted family room located behind the carport, which is ideal for use as a home office, workshop, hobby room, or additional storage.

Externally, the bungalow enjoys a substantial rear garden, perfect for entertaining, gardening, or offering future potential (subject to the necessary planning permissions).

This well-maintained home would appeal to a wide range of buyers seeking comfortable single storey living in a desirable setting.

## Other Information

Tenure: Freehold

Approximate Age: 1950's

Heating: Gas central heating

Windows: Double glazing

Loft: Not inspected

Energy Rating: D

Sellers Position: No forward chain

## Local Information:

Council Tax: C

Local Authority: Southampton City Council



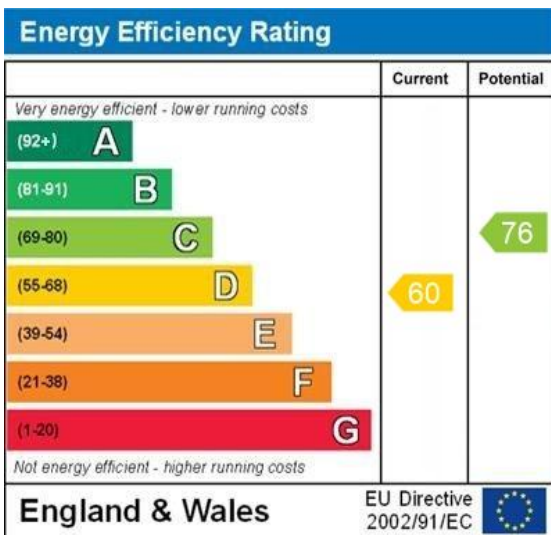

WWW.EPC4U.COM

### 36 Mon Crescent, Southampton

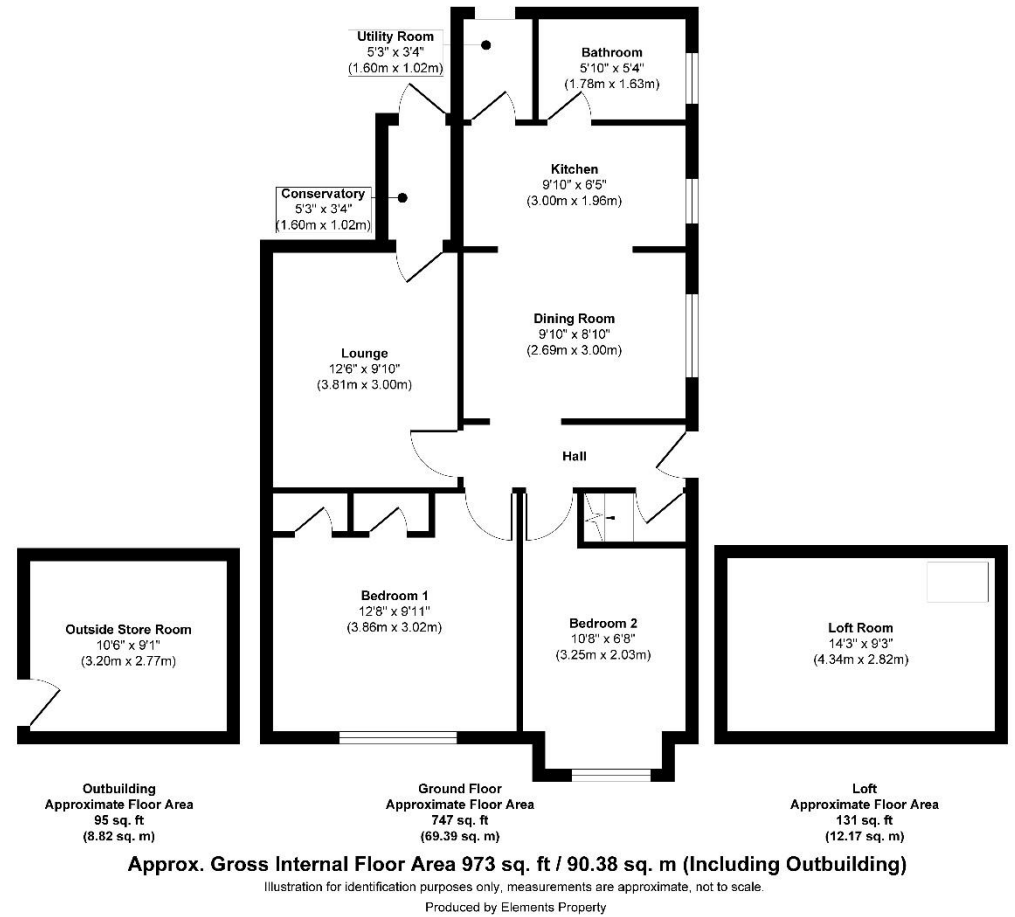

**Agents Note:** The sellers of the property have provided the above information to us and we are therefore reliant on them providing the correct information. The floor plan and sizes are to be used as a guide only. Please check room sizes prior to ordering carpets or furniture. If you require confirmation on any particular point for specific purposes please contact our office for further information. If you have other questions about this property, please telephone **01489 789933**

R545 Ravensworth 01670 713330

Lankester House, 1 Freegrounds Road, Hedge End, Southampton SO30 0HG • 01489 789933 • [admin@richmondsproperty.co.uk](mailto:admin@richmondsproperty.co.uk)



